

>>Pixi/3<<<

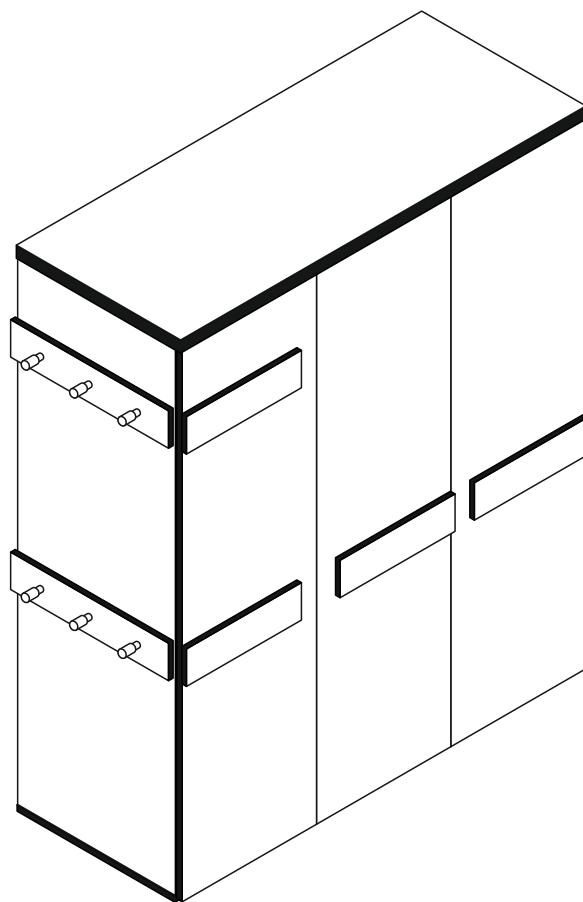

(D) Montageanleitung

(GB) Assembly instructions

(FR) Notice de montage

(TR) Montaj talimatı

(IT) Istruzioni di montaggio

(NL) Handleiding voor de montage

(RU) Инструкция по монтажу

(CZ) Montážní návod

(HU) Szerelési útmutató

(RO) Instrucțiuni de montaj

(PL) Instrukcja montażu

(SK) Návod na montáž

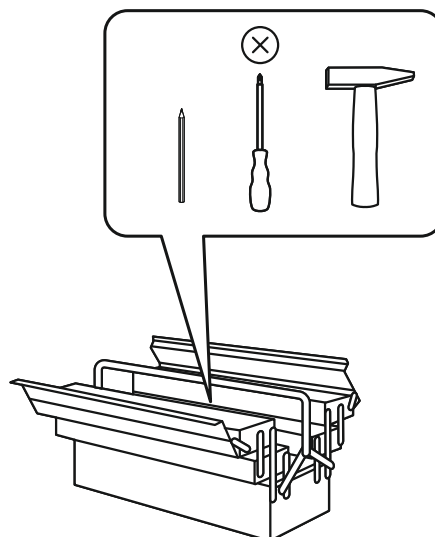
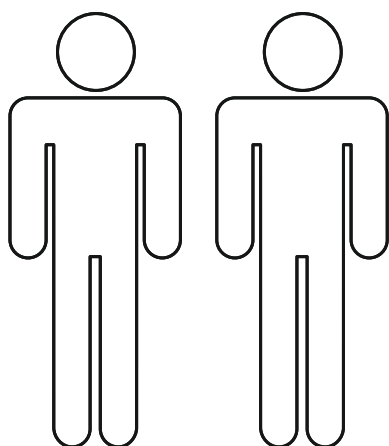

Service • Assistenza • Dienstverlening • Serwis Servis • Szerviz • Сервисная служба

Name • Nom • Nome • Naam • Nazwa • Jméno •
Názov • Név • Denumire • Ísm • Название

Pixi/3

Nr. • No. • N° • Номер • Č • Sz

0486/3

Typ • Type • Tip • Típus • Tipo • Тип

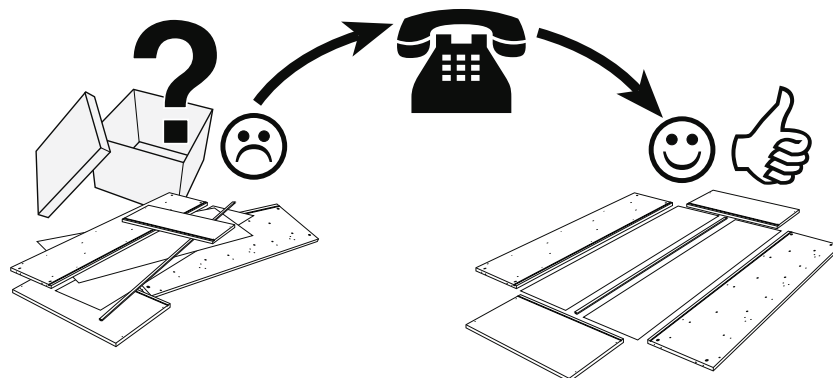
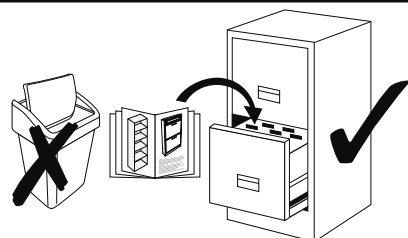

1-10 6x 6,3x50	1-30 31x 3x16	1-37 1x 4,5x25	1-80 32x 3,5x13	1-90 12x 3,5x20	1-120 1x 3,5x45
1-125 6x 4x25	1-190 6x M4x20	1-331 6x M4x37	1-351 12x M4	2-10 14x M4	2-20 14x M4
2-114 4x L-shaped	2-171 12x Circular	3-11 9x L-shaped	3-41 6x L-shaped	3-42 3x L-shaped	3-81 3x L-shaped
3-82 3x L-shaped	3-130 6x L-shaped	5-70 12x L-shaped	5-130 1x L-shaped	5-185 6x L-shaped	6-100 6x L-shaped
8-50 1x L-shaped	8-60 1x L-shaped	15-2x L = 862 mm			

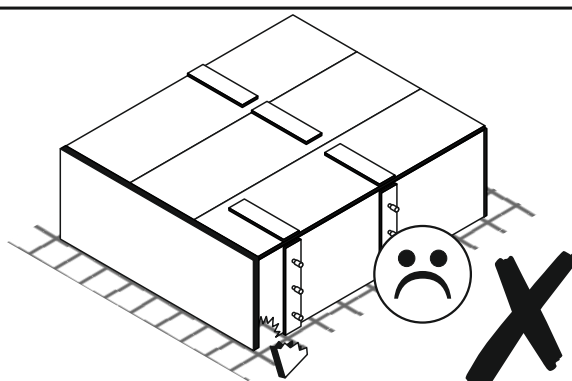
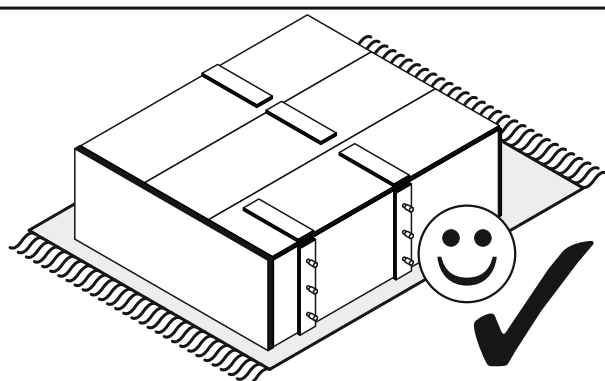
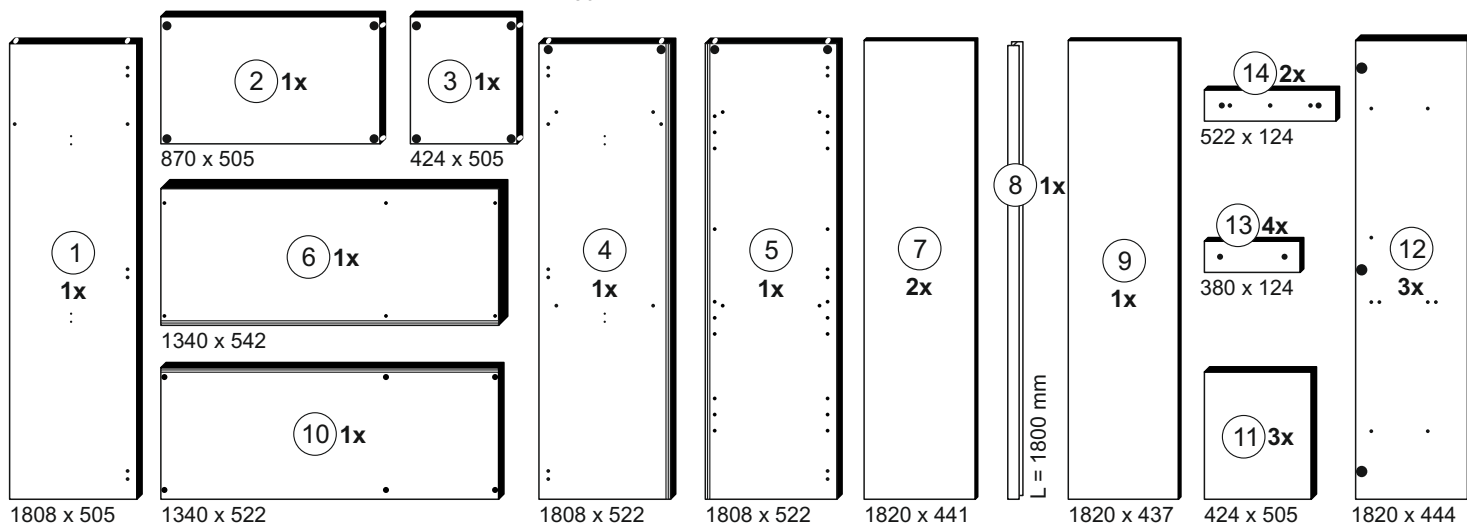

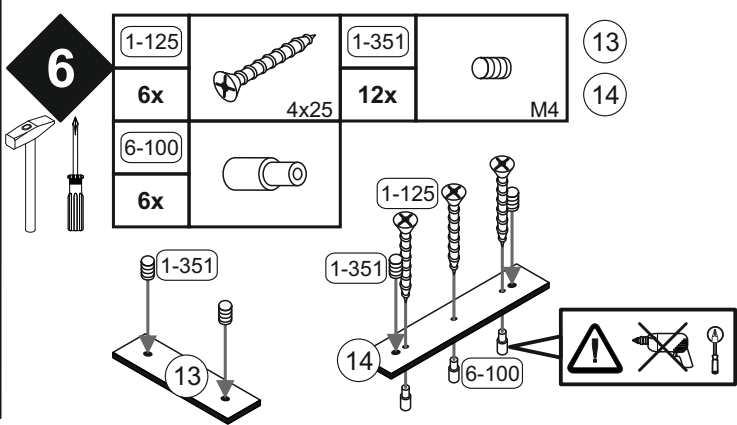
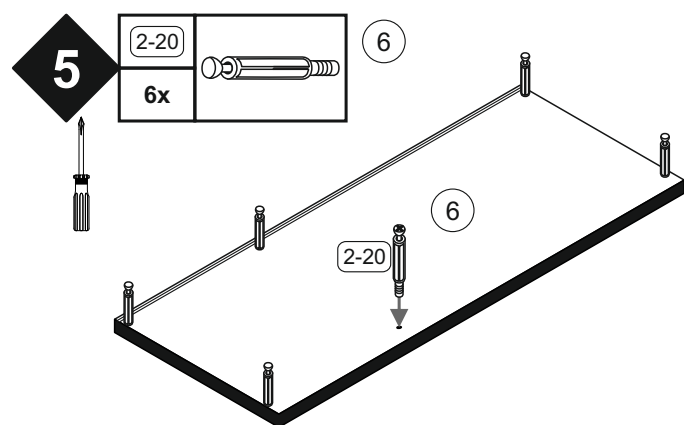
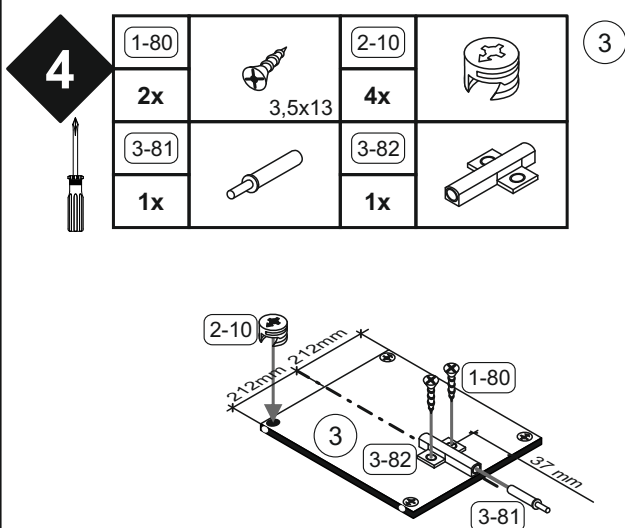
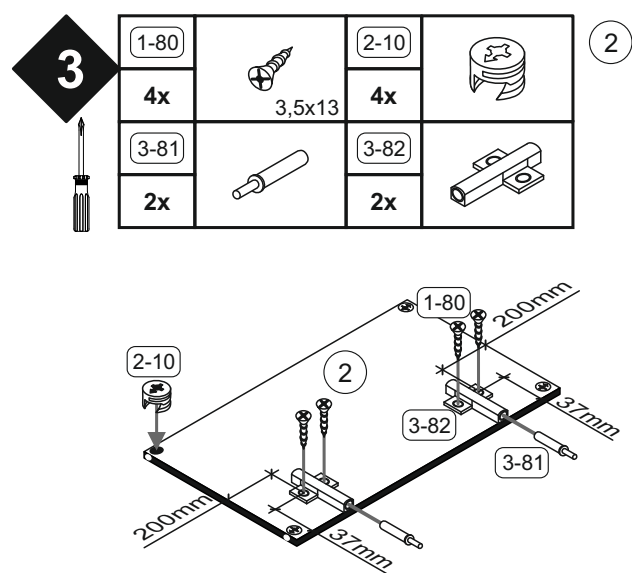
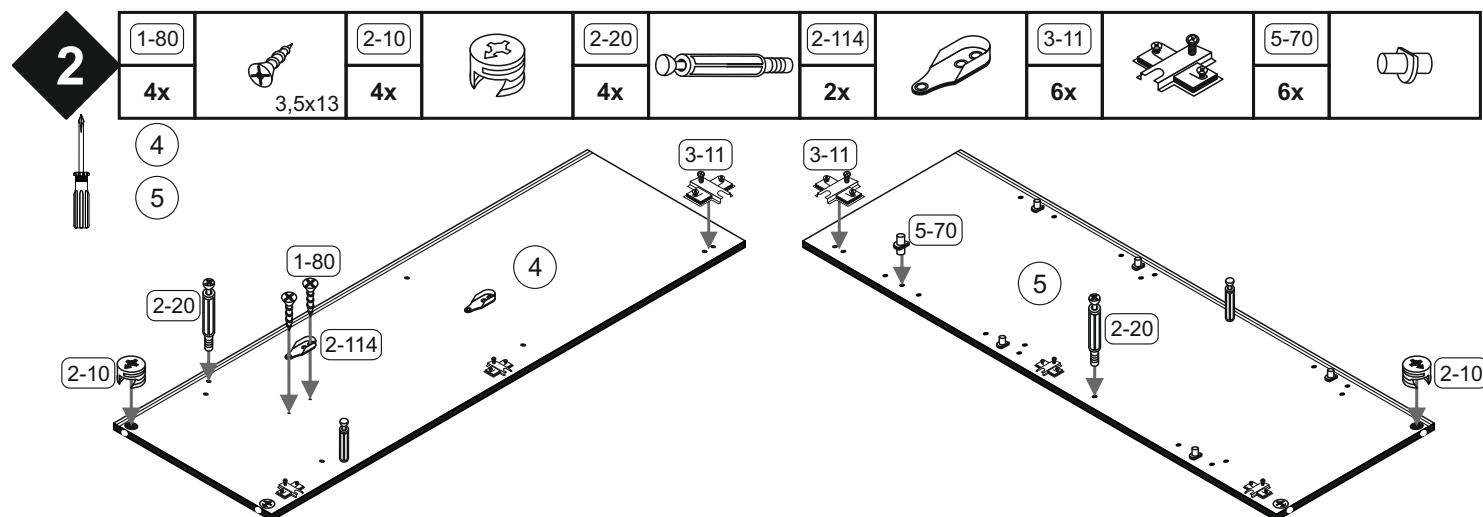
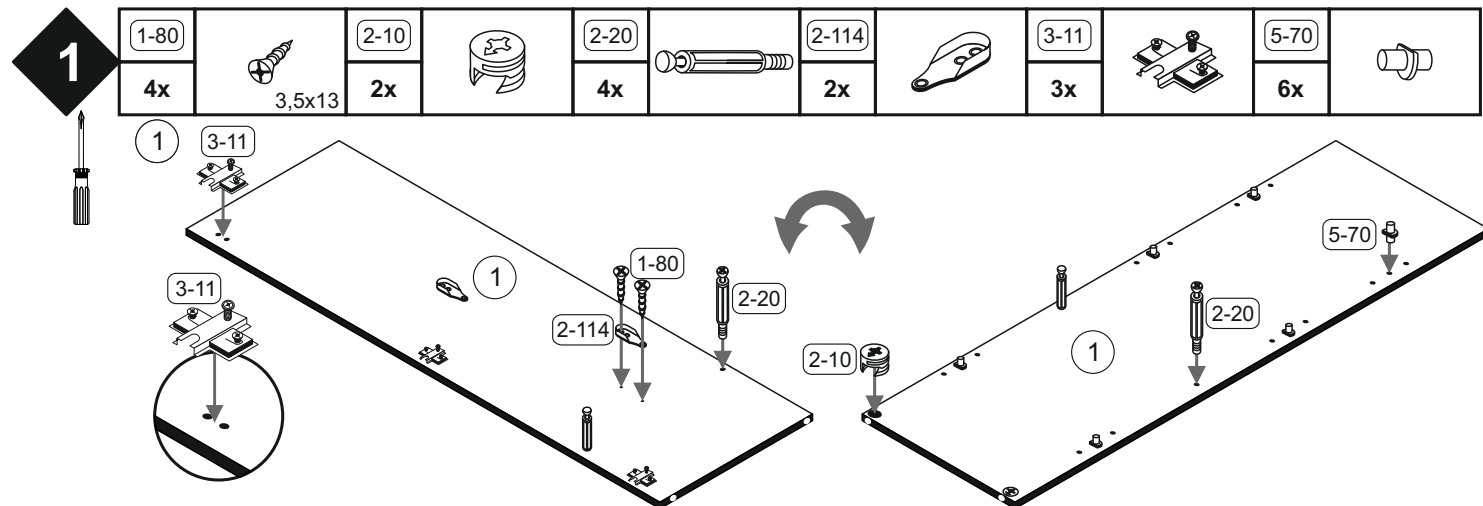

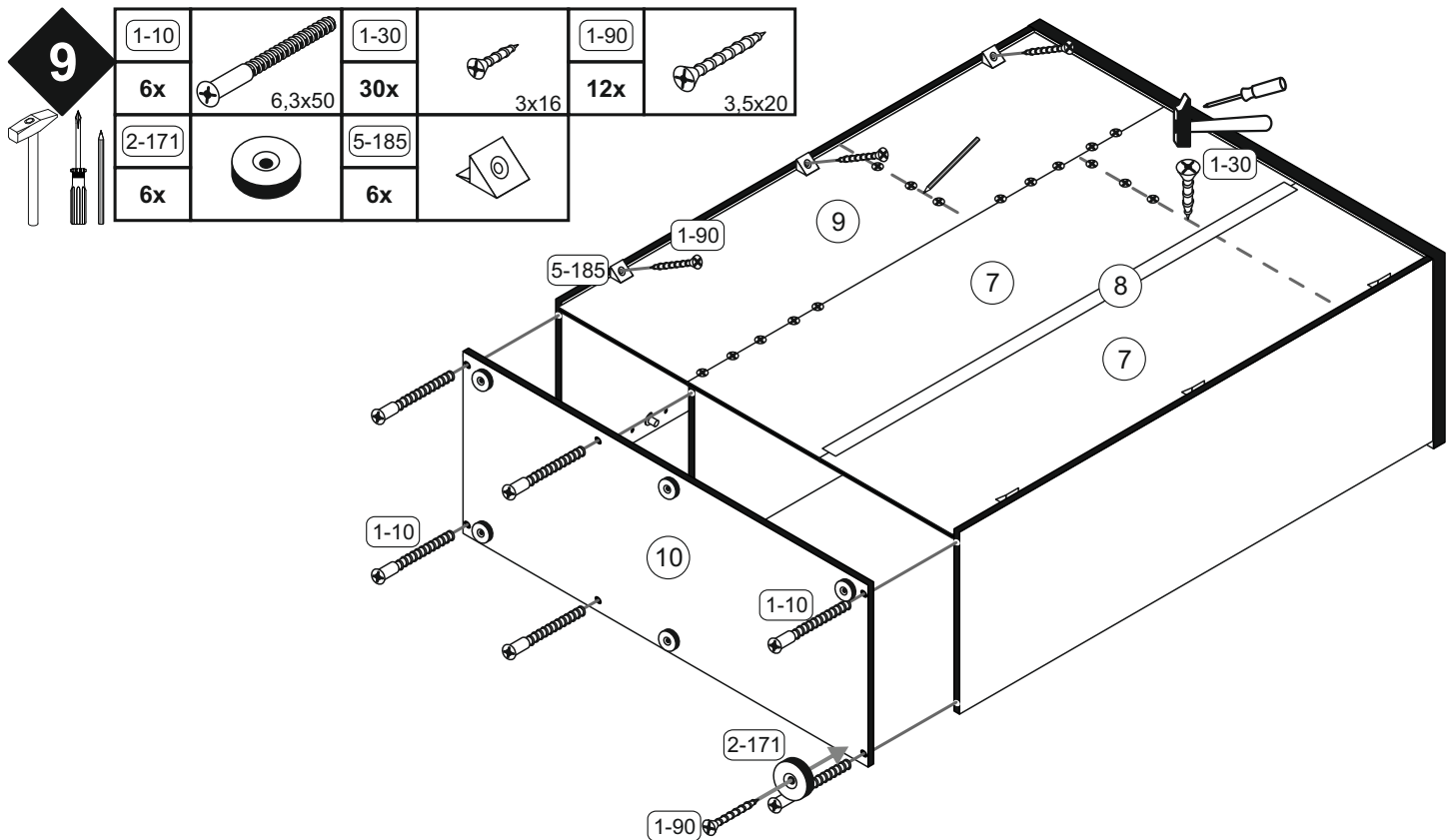
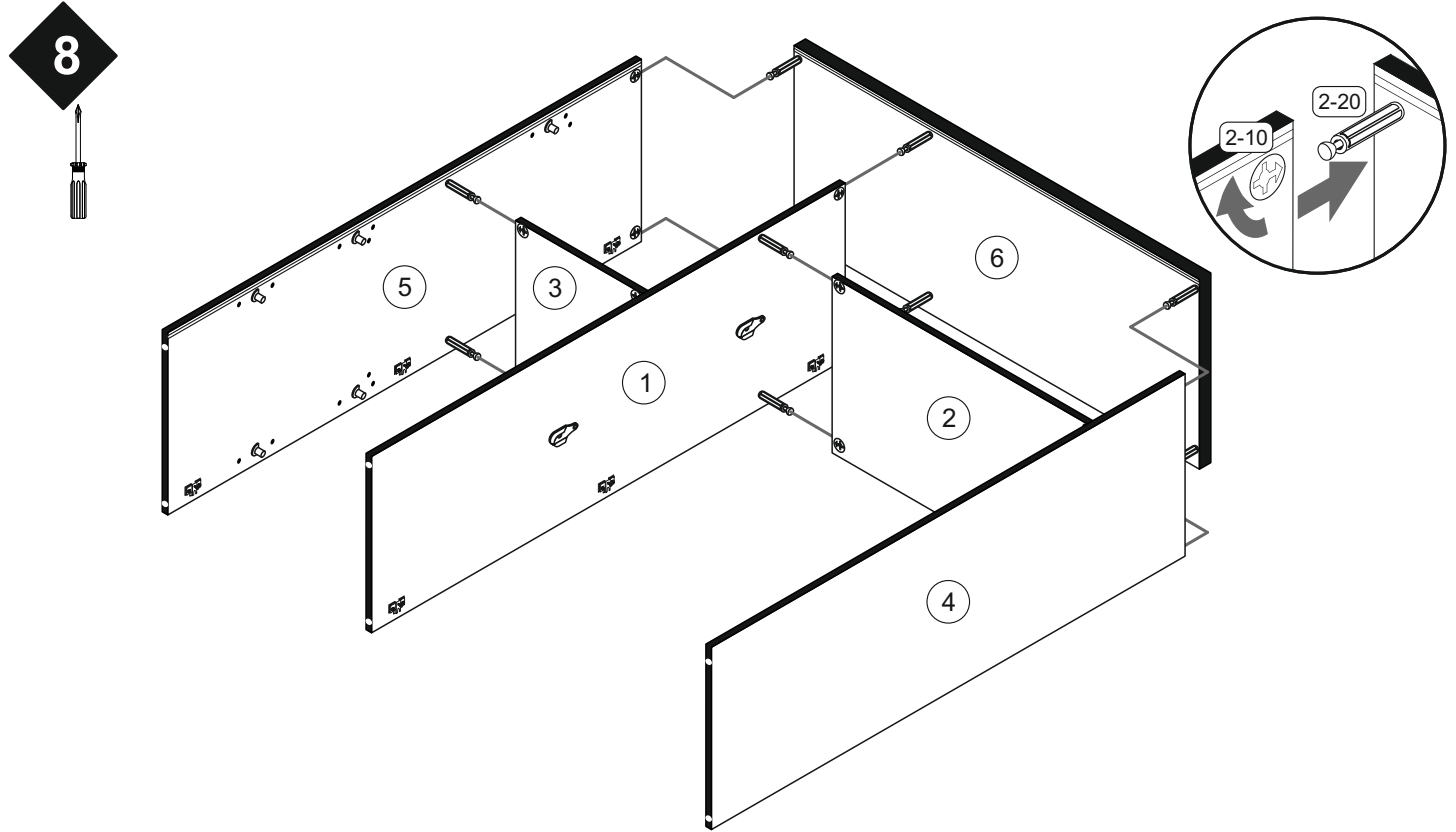
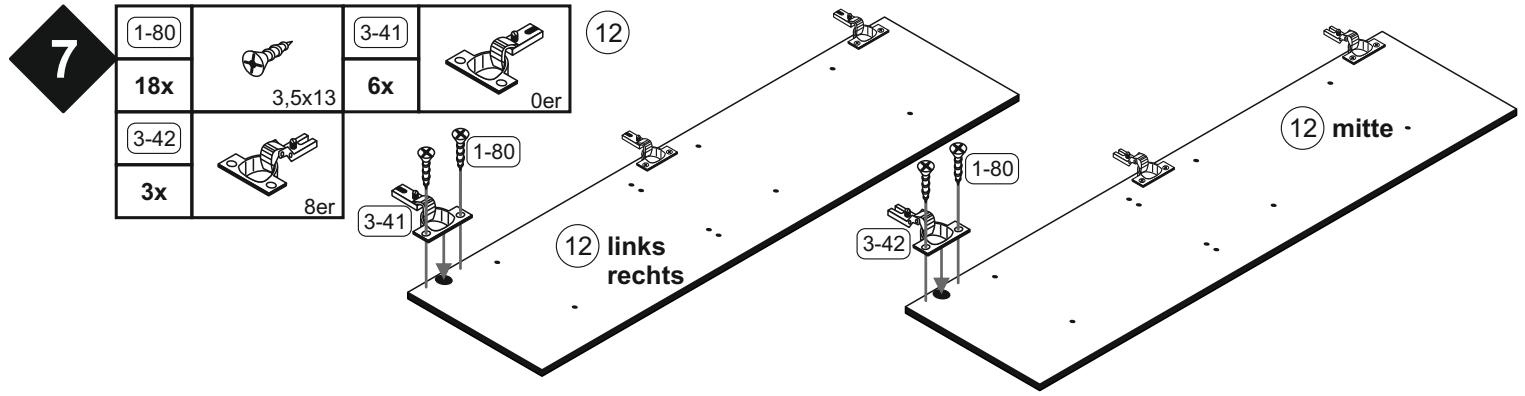

10	1-30 1x	3x16	1-120 1x	3,5x45	1-190 6x	M4x20	3-130 6x		8-50 1x	8-60 1x	Ø6
----	------------	------	-------------	--------	-------------	-------	-------------	--	------------	------------	----

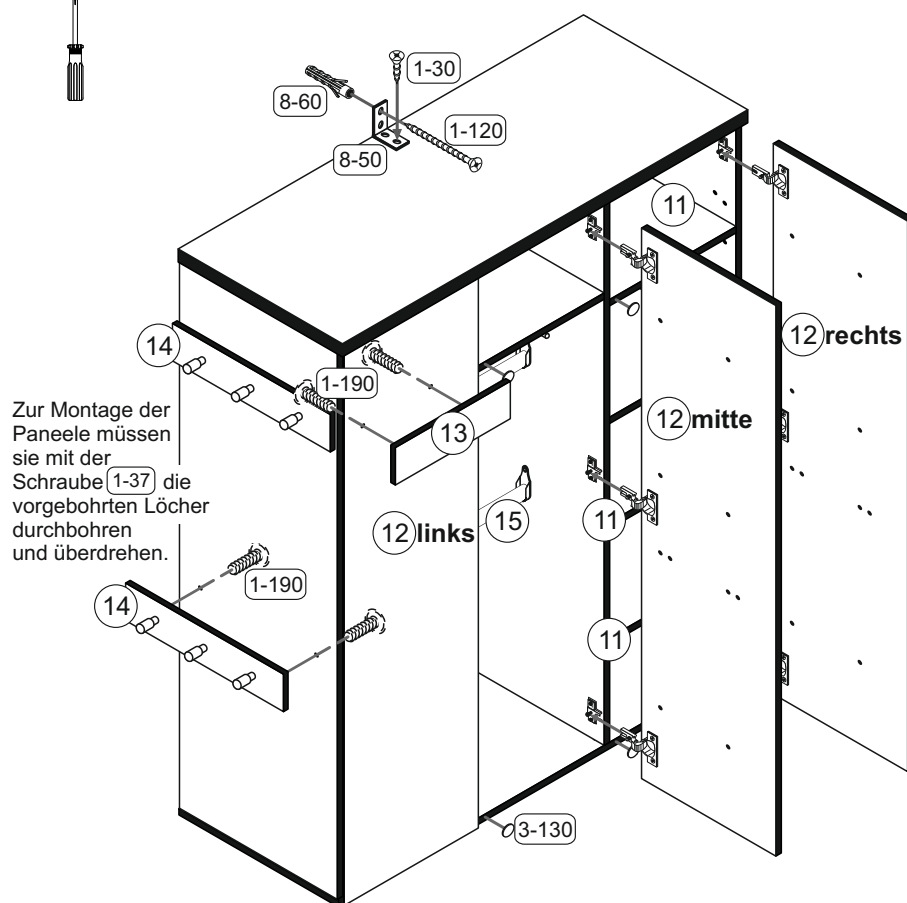

Zur Montage der Panele müssen sie mit der Schraube 1-37 die vorgebohrten Löcher durchbohren und überdrehen.

Türen einstellen (Scharniere justieren)

Adjusting the doors (adjusting the hinges)

Régler les portes (ajuster les charnières)

Sistemare le porte (regolare le cerniere)

Deuren instellen (scharnieren afstellen)

Nastawić drzwi (wyregulować zawiasy)

Vyrovnejte dvířka (seřid'te závěsy)

Nastavenie dverí (nastavenie závesov)

Állítsa be az ajtókat (állítsa be a zsanérokát)

Reglare uși (ajustare balamale)

Kapıların ayarlanması (mentşelerin seviye ayarı)

Регулировка дверей (регулировка шарнира)

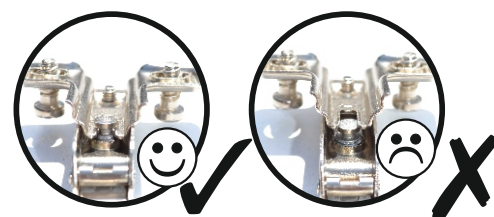
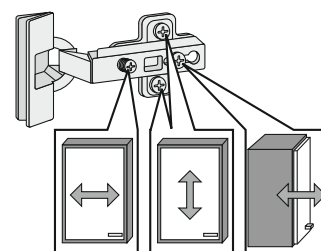

11	1-37 1x	4,5x25	1-331 6x	M4x37	2-171 6x	
----	------------	--------	-------------	-------	-------------	--

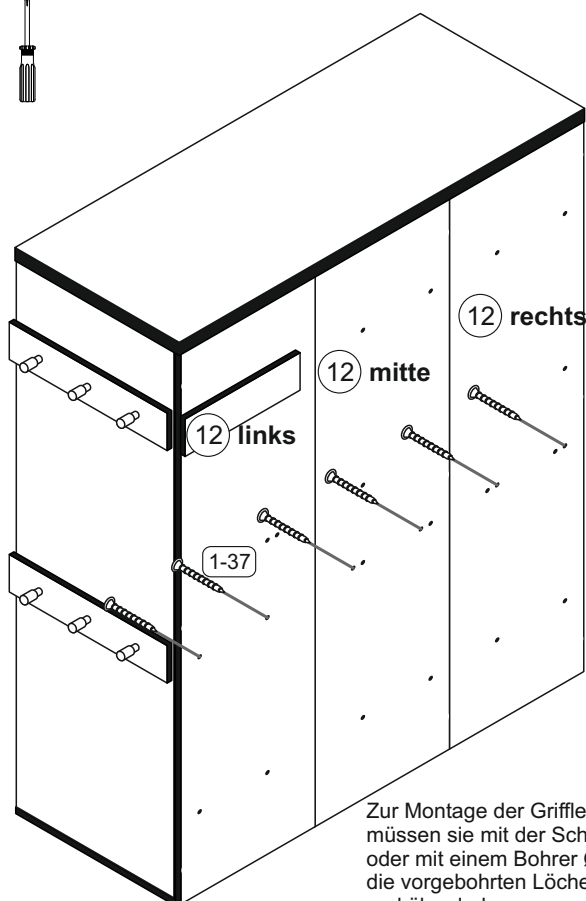

Zur Montage der Griffleisten müssen sie mit der Schraube 1-37 oder mit einem Bohrer Ø5mm die vorgebohrten Löcher durchbohren und überdrehen.

